

MAINTENANCE AND TROUBLE SHOOTING

PROBLEM	PROBABLE CAUSE	ACTION
Does not fire point	Out of points	Reload new stack of points
	Point jammed	Remove points and magazine. Remove jammed points and clean magazine
Fires double points Point penetration not deep enough	Magazine screw loose	Tighten nut firmly
	Magazine screw loose	Tighten nut firmly
	Frame not firmly backed up	Use firm backing
	Pressure adjustment loose	Tighten pressure screw

PARTS LIST

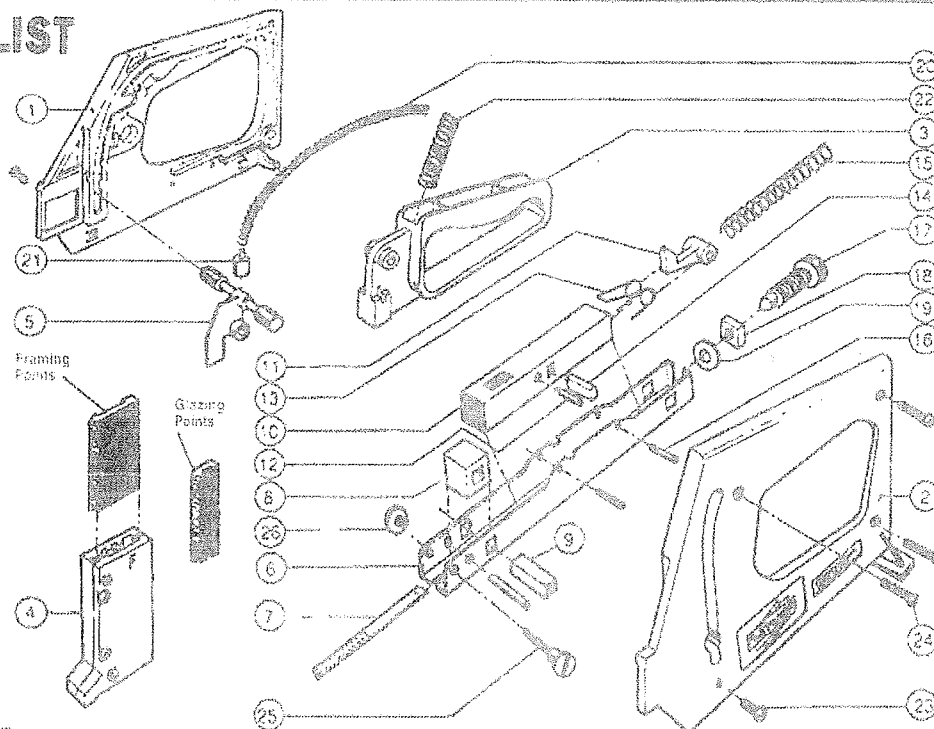

ORDER			ORDER		
ITEM NUMBER	PART NAME	QTY	ITEM NUMBER	PART NAME	QTY
1 12-777	Handle (Rt. Hand)	1 *	14 12-713	Spring Stop Plate	1
2 12-778	Handle (Left Hand)	1 **	15 12-714	Main Spring	1
3 12-779	Trigger Assembly	1	16 12-715	Guide Pin	3
4 12-728	Magazine Assembly	1	17 12-716	Adjusting Knob	1
5 12-704	Follower Assembly	1	18 12-717	Square Nut	1
6 12-776	Channel Assembly	1	19 12-718	Washer	1
7 12-730	Push Plate	1	20 12-719	Follower Spring	1
8 12-707	Bumper	1	21 12-720	Cap	1
9 12-708	Stop Bar	1	22 12-721	Trigger Spring	1
10 12-709	Hammer	1	23 12-722	6-32 x 3/8 Screw	2
11 12-710	Pawl	1	24 12-723	8-16 x 5/8 Screw	3
12 12-711	Pawl Pin	1	25 12-731	Magazine Screw	1
13 12-712	Dbt Torsion Spring	1	26 12-725	Magazine Nut	1

* Must be purchased with 12-778

** Must be purchased with 12-777